

GRAND BALLROOM  
LOWER LOBBY

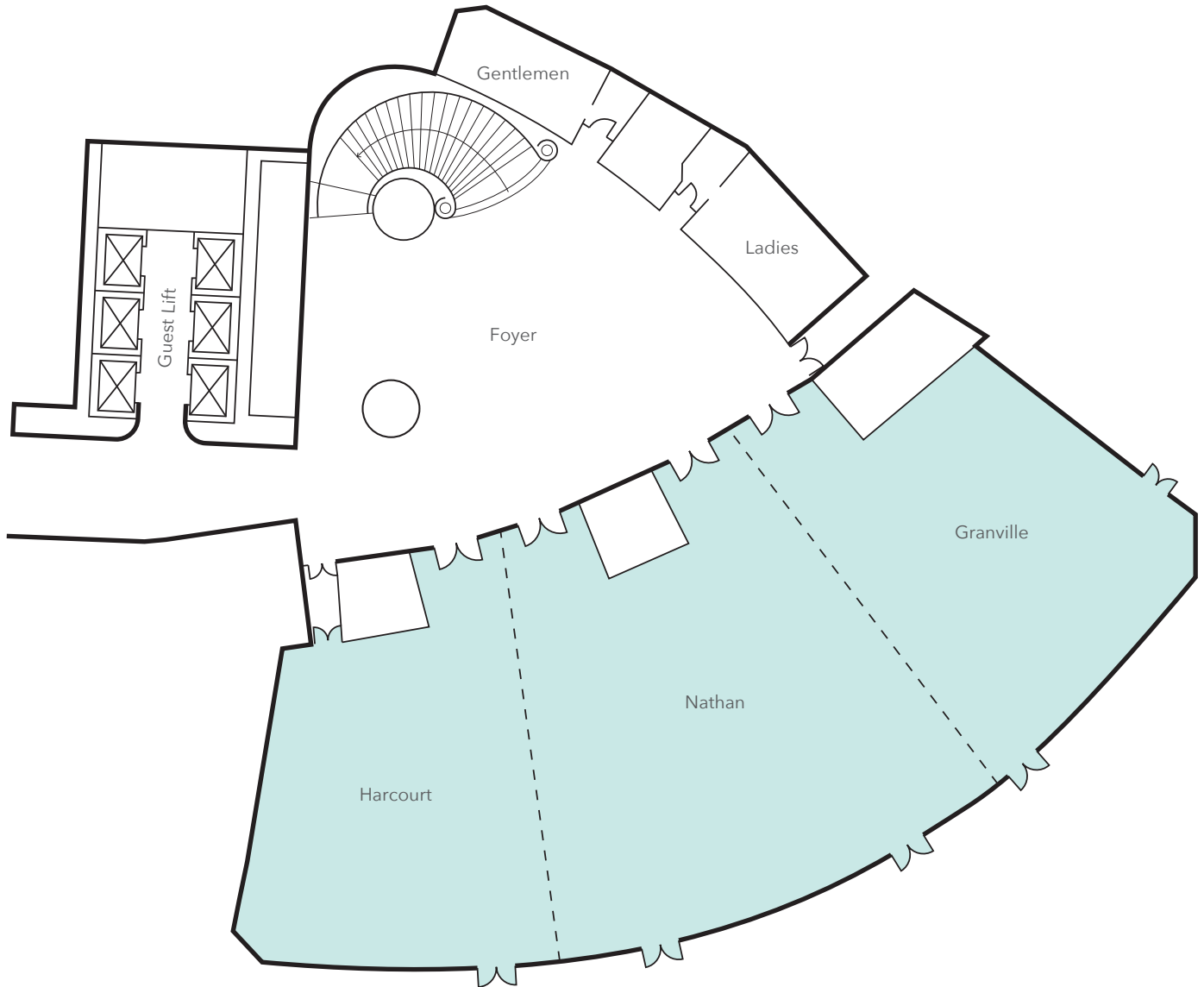

Room	Area		Dimensions		Height		Capacities					
	Sqm	Sqft	Metres	Feet	Metres	Feet	Classroom	Theatre	Banquet	Reception	Dinner/Dance	U-shape
Grand Ballroom	767	8,242	20 x 46.6	64' x 153'	4.5	15'	400	700	624	1000	516	90
Granville	231	2,484	20 x 14	63' x 46'	4.5	15'	84	200	132	250	96	40
Nathan	311	3,344	20 x 21	65' x 69'	4.5	15'	124	300	180	400	144	48
Harcourt	225	2,414	20 x 14	64' x 46'	4.5	15'	84	200	132	250	96	40
Nathan + Granville	542	5,828	20 x 31	63' x 93'	4.5	15'	208	500	384	650	312	78
Harcourt + Nathan	536	5,758	20 x 31	63' x 93'	4.5	15'	208	500	384	650	312	78

**FUNCTION ROOMS  
LEVEL 7**

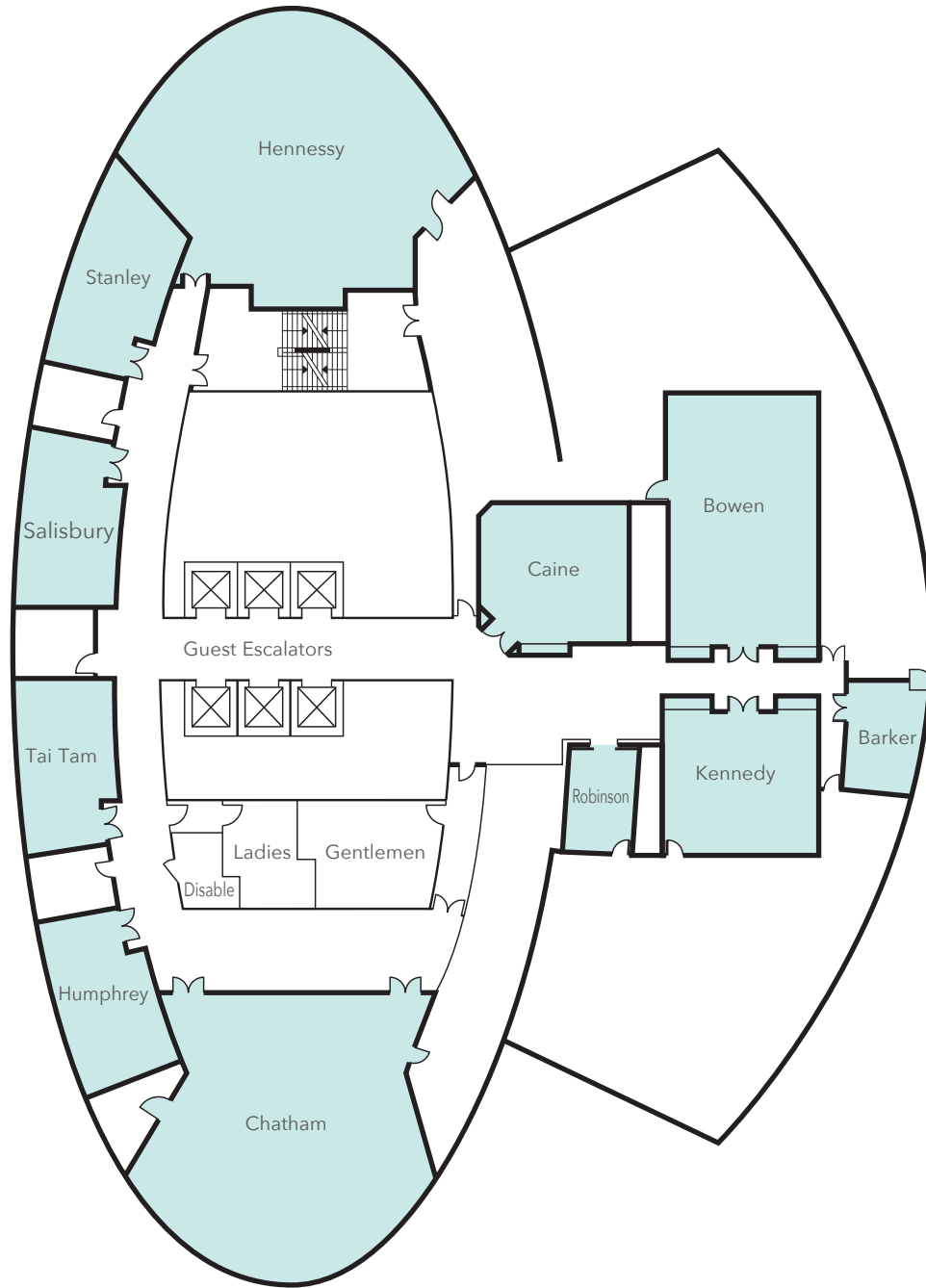

Room	Area		Dimensions		Height		Capacities					
	Sq m	Sq ft	Metres	Feet	Metres	Feet	Classroom	Theatre	Banquet	Reception	Dinner/Dance	U-shape
Chatham	151	1,625	13.7 x 14	45' x 46'	2.7	9'	88	180	108	180	-	36
Hennessy	145	1,560	13.4 x 14.3	44' x 47'	2.7	9'	72	150	96	150	-	35
Stanley	34	370	4.3 x 9.1	14' x 30'	2.7	9'	16	24	24	30	-	12
Salisbury	34	370	4.6 x 8.2	15' x 27'	2.7	9'	16	24	24	30	-	12
Tai Tam	34	370	4.6 x 8.2	15' x 27'	2.7	9'	16	24	24	30	-	12
Humphrey	34	370	4.3 x 8.5	14' x 28'	2.7	9'	16	24	24	30	-	12
Bowen	86	930	12.8 x 7	42' x 23'	2.4	8'	48	80	72	80	-	30
Kennedy	52	560	7.3 x 7	24' x 23'	2.4	8'	24	45	48	45	-	17
Caine	49	530	7.3 x 7	24' x 23'	2.4	8'	24	40	36	40	-	17
Barker	26	285	4.9 x 7	16' x 23'	2.4	8'	8	(Boardroom)				
Robinson	17	180	5.2 x 3.7	17' x 12'	2.4	8'	8	(Boardroom)				